

A yellow excavator is the central focus of the image, positioned against a clear blue sky with a few wispy clouds. The excavator's arm is extended upwards and to the right, with its bucket pointing towards the top right corner. The lighting is bright, suggesting a sunny day. The overall composition is clean and professional, suitable for a corporate or technical advertisement.

C-TECH ENGINEERS

An ISO 900:2015 Certified Company

D & B D-U-N-S Number 91-852-2467

Export House Status

TOTAL SOLUTIONS FOR MACHINES COMPONENTS

Know Us

C-Tech Engineers Pvt. Ltd. is an organization incorporated in 2001 to achieve a milestone to be a global solution for Pins, Bushes and Precision Machined Components.



WE
ACHIEVE
CUSTOMER
SATISFACTION
THROUGH

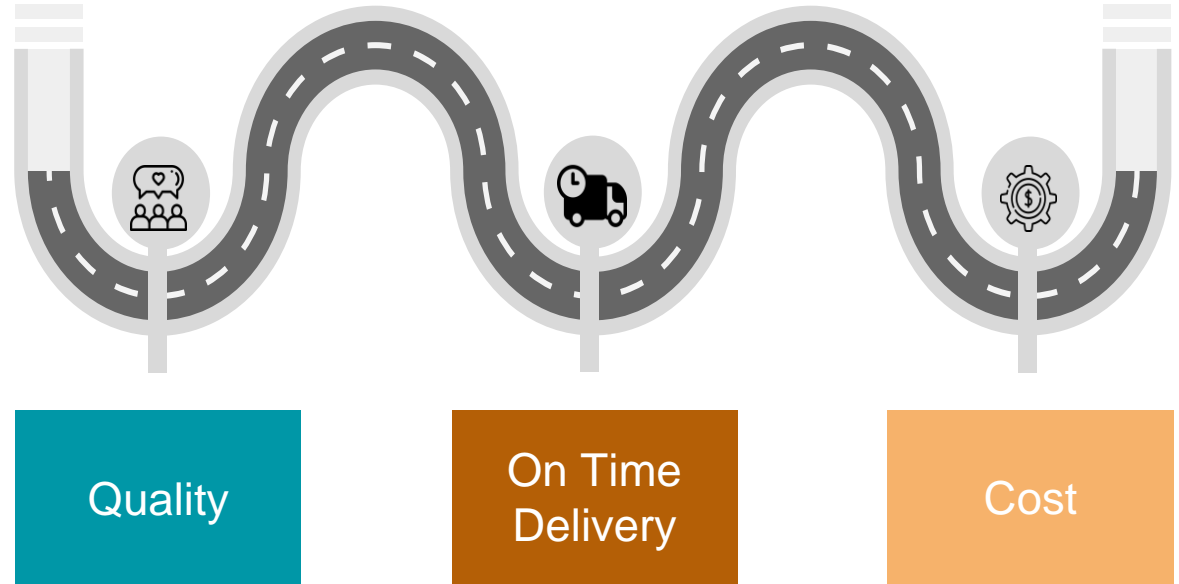

KNOW OUR LEADERS

“The greatest leader is not necessarily the one who does the greatest things. He is the one that gets the people to do the greatest things.” – Ronald Reagan

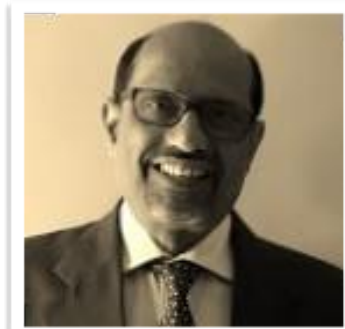

A.M Chabukswar
Director



S.D.Mutha
Director

A. M. Chabukswar
Director



S. D. Mutha
Director



Accounts Chief
Sanjeevan Moghe



Operation Head
Vivek Kulkarni



Accounts, Excise, Dispatch
G. M. Kalasheti



Plant Head
II
Prakash
Ramdasi



Prod. Asst.
III
Tushar
Kadam



Plant Head
I & IV
Mahadev
Karbhari



Purchase
Uday
Chougala



Development
In-charge
Nilesh Kirane



Marketing Asst.
Vijaykumar
Karvekar



HR, Admin
Head
Ajit More



Quality Asst.
II
Mukesh Singh



Quality Head
I & III
Arvind Mane



Quality Head
IV
Sagar Kande



Marketing Asst.
Ravindra
Bagul

MEETING CUSTOMER REQUIREMENT IS AN INTEGRATED SYSTEM

03



- Zero Rejection PPM
- Innovation
- Advance Equipment and Facility

Technology

02



- On Time Delivery
- Prompt Action and Loyalty
- Long Term Association

Client

01



- Quality Assurance
- Quantity Flexibility
- Cost Effectiveness

Product

STAR PERFORMER EXPORTER AWARDS

*Winner for Consecutive 14 years!
2004 - 2017 :*



INFRASTRUCTURE

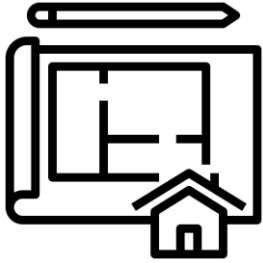

35,000 Sq.Ft
Working Area

40,000 Sq.Ft
Open Space for future
extension

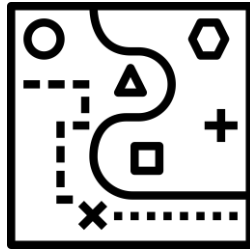

HUMAN RESOURCES



Qualified Experienced
Engineers



2nd Level Managers
for QC and
Production



Skilled Workers



Semi-Skilled Workers

ADVANCE MACHINE FACILITY



**CNC Turn Mill
Centre**

**Horizontal Bed CNC
Lathe Machine**



BFW Agni

QUALITY FACILITY



**Trimos height
Gauge**



Profile Projector



CMM

SUNBRIGHT HEAT TREATMENT PVT. LTD.

SISTER CONCERN

We have advanced technology, sealed quench furnace and Testing Lab Equipment's. Furnace is equipped with PLC controller & having furnace capacity of 1.5 Ton per day. We have our own advanced metallurgical test laboratory to inspect and analyze the results of the various treatments performed in the plant.

- **Carburizing**
- **Carbonitriding**
- **Case Hardening**
- **Through Hardening & Tempering**
- **Normalizing**



PRODUCTION FACILITY



SOCIAL & ENVIRONMENT POLICY

Object: Be a Part of the Society..



SOCIAL RESPONSIBILITY ACTIVITIES

- Anti-Addiction Campaign for Students From 8th STD to 12th STD with Two Groups from Pune
- A Contribution to society spreading awareness about No-addiction of any type of drugs or tobacco.
- Total no. of School Visited : 50 nos.
- Total no. of Students pledged: 8000 nos.



WORLD WIDE SUPPLY

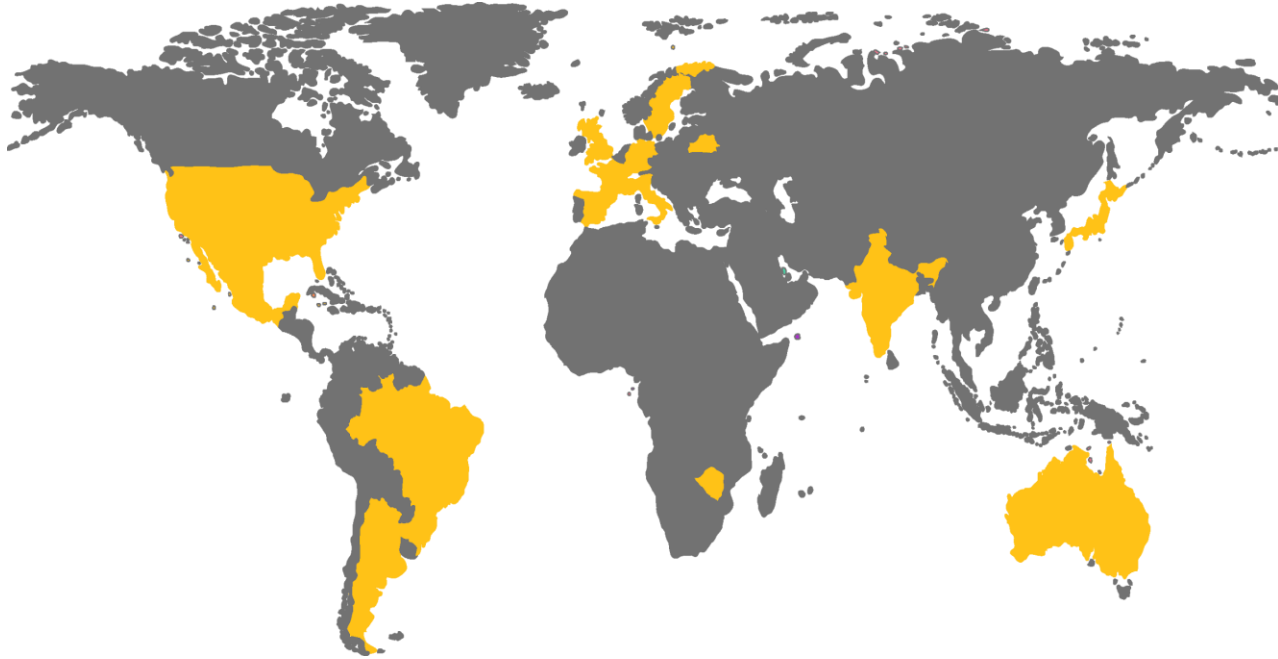

GERMANY, FRANCE, UK, ITALY, FINLAND, SWEDEN, SPAIN, AUSTRALIA,
USA, BRAZIL, ARGENTINA, MEXICO, JAPAN, ZIMBABWE

MARKET SHARE

REGION WISE

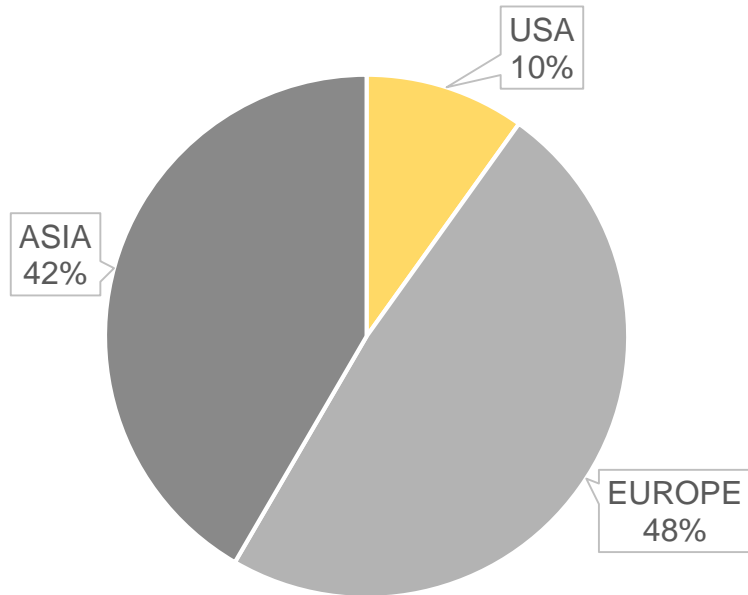

■ USA ■ EUROPE ■ ASIA

SECTOR WISE

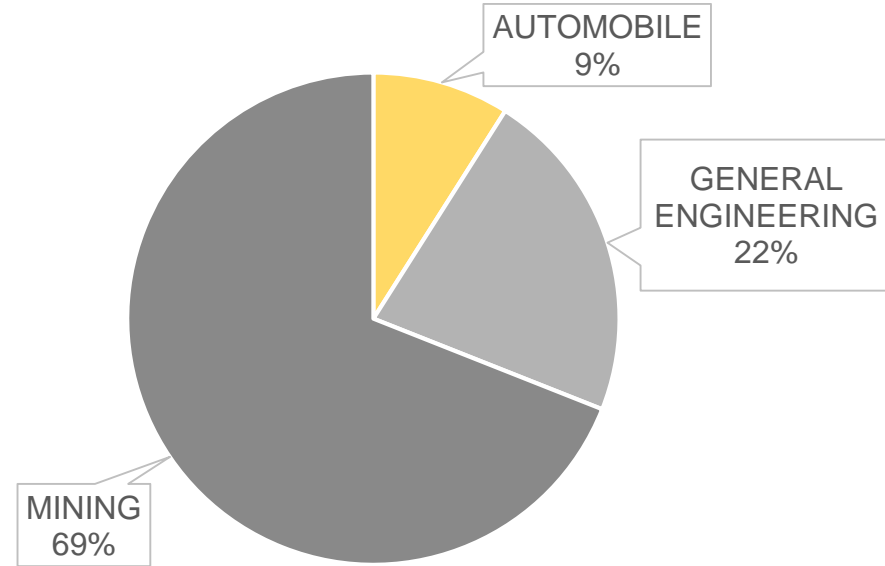

■ AUTOMOBILE ■ GENERAL ENGINEERING ■ MINING

GROWTH PATH

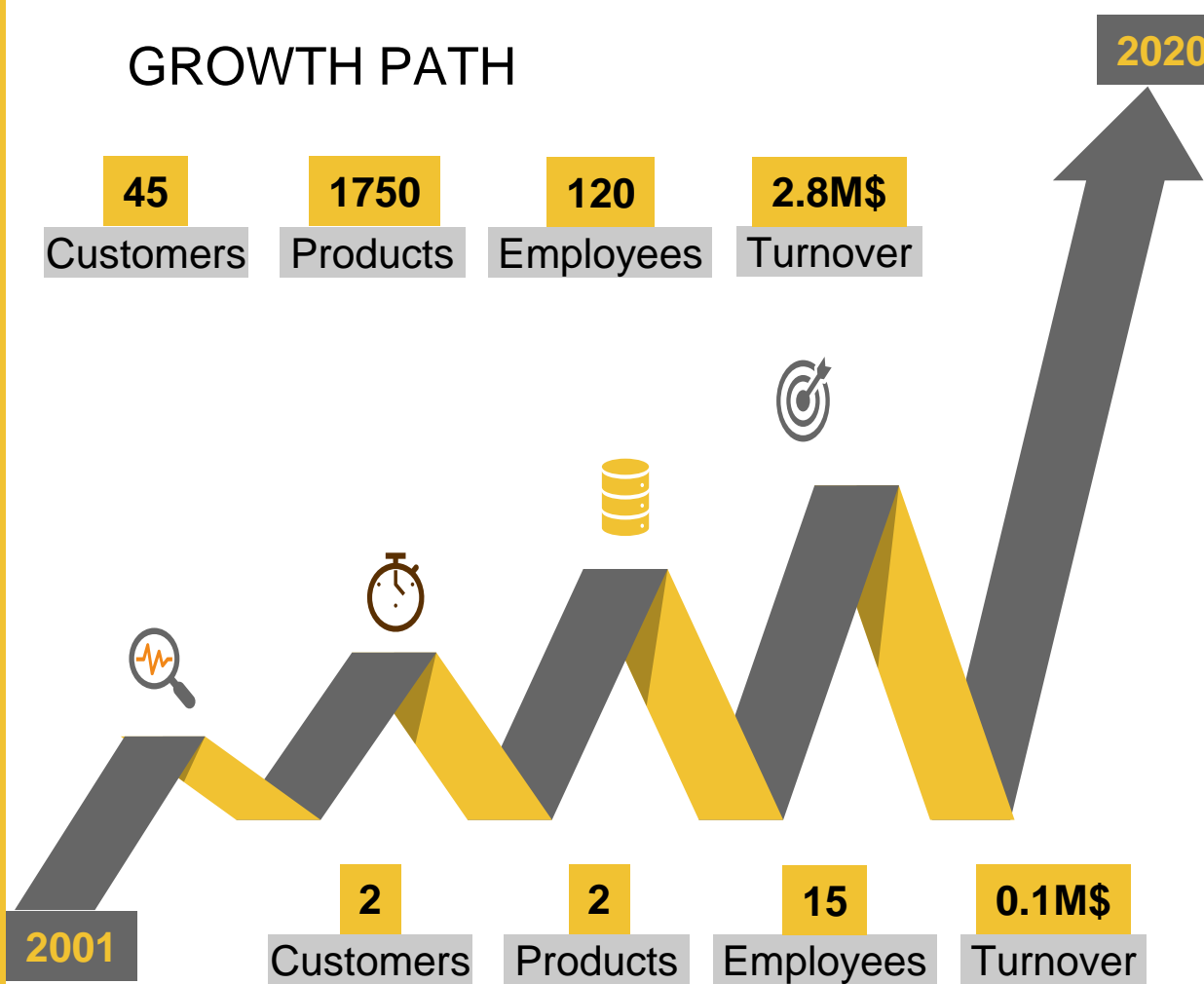

- Client Presence In More Than 15 Countries
- Jigs and Fixtures development facility
- Strong Vendor Network
- Heat Treatment Facility
- International Approval ISO 9001-2015 from ICS
- Special Purpose Machines
- CMM Facility

CLIENTS - EXPORT



Profit is the applause you get for taking care of your customers and creating a motivating environment for your employees.



CLIENTS - DOMESTIC



The goal as a company is to have customer service that is not just the best but legendary.



PINS AND BUSHES

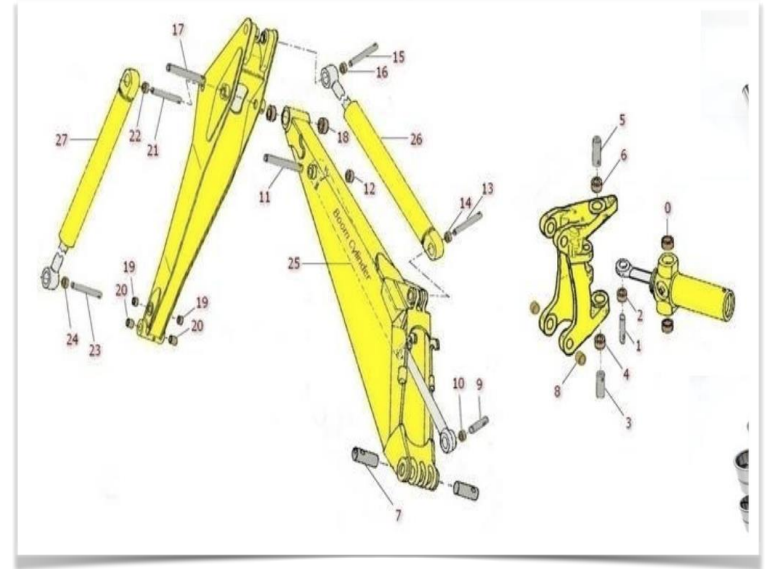

Keeping your Ground engaging equipment working in a straight line means keeping the pins ,bushes and linkages in tip top condition.



AUTOMOTIVE



Connectors and Press Rings



Flanges

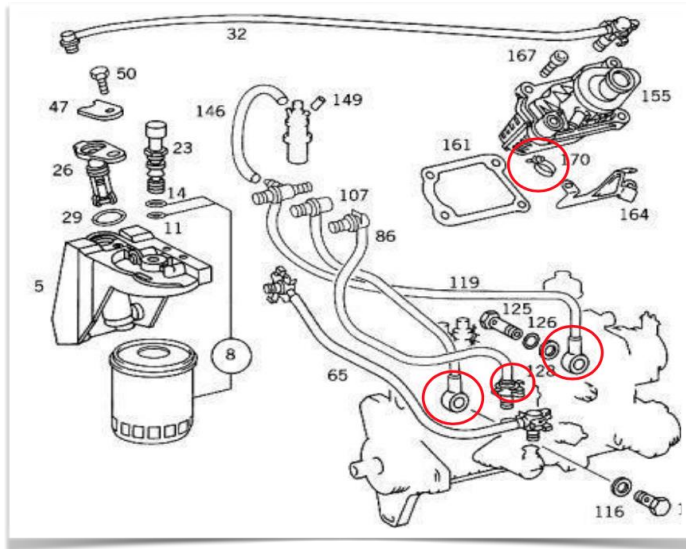

Benjo

PINS



SPEC.	DESCRIPTION
Max. Outer Dia \varnothing	140.00 mm
Min. Outer Dia \varnothing	15.00 mm
Max Length	1000.00 mm
Heat Treatment	Through Hardening / Case Hardening / Induction Hardening
Hardness	52-64 HRC / As per customer's requirement
Case Depth	0.5 to 5.0 mm
Raw Material (Preferred)	C45(EN8D),SAE4140(EN19), SAE52100(EN31), 16MnCr5,20MnCr5 Or As Per Customers Requirement
Welding	End Plate Welding, Co2 / Argon

HARDENED GROUND BUSHES WITH MOLYKOTE COATING, BRONZE BUSHES



SPEC.	DESCRIPTION
Max. Outer Dia \varnothing	150.00 mm
Min. Inner Dia \varnothing	25.00 mm
Max Length	150.00 mm
Heat Treatment	Through Hardening / Case Hardening / Induction Hardening
Hardness	52-64 HRC / As per customer's requirement
Case Depth	0.5 to 2.5 mm
Raw Material (Preferred)	C45 (EN8D), SAE 4140 (EN19), SAE52100 (EN31), 16MnCR5, 20MnCR5, Or As Per <u>Customers Requirement</u>
Grooving Type	Helix Angle, 8 Shaped, Knurling Or As Per Customers Requirement

PRECISION COMPONENTS AND PART ASSEMBLY



Part Assembly

Precision Components



BOSSES AND MACHINE COMPONENTS



Soft Bosses, Bronze Bosses

Machined Components



SPARE FOR MINING EQUIPMENT



MINING EQUIPMENT

SK 1854



SK216



MINING EQUIPMENT

MECH
22B



An ISO Certified Company

CERTIFICATE OF COMPLIANCE



INTERNATIONAL CERTIFICATION SERVICES PVT. LTD.

This is to certify that the
QUALITY MANAGEMENT SYSTEM of

C-TECH ENGINEERS PVT. LTD.

Survey No.25, Hissa No.6, Narhe, Tal. Haveli, Dist. Pune - 411 041, Maharashtra, India
Survey No. 30/27 E,Dhayari, Tal. Haveli, Dist. Pune - 411 041, Maharashtra, India

has been assessed and registered as complying with the requirements of the following International Standard:

ISO 9001:2015

The Quality Management System applicable to:

Scope : Manufacture and supply of Precision Machined Components and Sub Assemblies.

Registration No. : RQ91/7125
Registered Date : 16th April, 2005
Reassessment Date : 10th August, 2020
Issue Date : 31st August, 2020
Expiry Date : 15th April, 2023



Antonia

Director

International Certification Services Pvt. Ltd.

Accredited by Joint Accreditation System of Australia and New Zealand

Validity of this certificate is based on periodic audits of the management system defined by the above scope and is contingent upon prompt, written notification of significant changes to the management system and/or its components thereof shall be immediately communicated to ICS. Further clarifications regarding the scope of this certificate and the applicability of ISO 9001:2015 requirements may be obtained at www.icsasian.com

22/23, Goodwill Premises, Swastik Estate, 178 CST Road, Kallina, Santacruz (E), Mumbai - 400 098, Maharashtra, India. Tel.: 022-42200900

ISO 9001:2015

We are in process of

ISO/TS
16949

ISO
45001-2018

ISO
14001-295

December
2021



THERE IS NO SHORTAGE OF REMARKABLE
IDEAS,
WHAT'S MISSING IS THE WILL TO EXECUTE
THEM!



THANK YOU.....